

rod seal S01-SC

seal spec

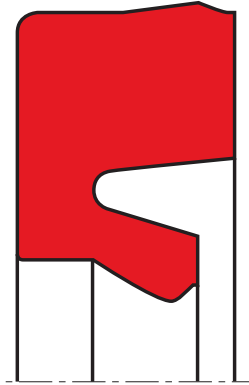

description

the profile S01-SC rod seal is a lip seal specially developed for use in pneumatics. use in pneumatics. due to their special structural design, the profile S01-SC rod seals offer the following advantages when used in pneumatic equipment:

- small installation grooves.
- sealing lip geometry designed to operate with lubricated air as well as dry and oil-free air.
- lip seal design and tight fit into the groove ensure reliable operation.
- optimal friction characteristics after careful initial lubrication obtained by sealing lip geometry retaining lubrication film.
- easy snap assembly in grooves of simple design.
- extended service life due to the use of proven elastomers.

application

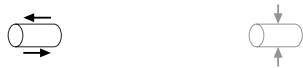

not bolded symbols; please consult our technical for application limitations

category of profile

machined or molded/standard/trade product.

single acting

the S01-SC seal is designed for use as a rod seal.

area of application: pneumatic

medium: lubricated air as well as dry air and oil-free air (after initial lubrication on assembly).

operating parameters & material

material	temperature	max. surface speed	max. pressure ¹
s-mart NBR (80 Shore A)	-20°C ... + 80°C	1 m/s	16 bar (1,6 MPa)

standard compound is the special SFR® elastomer (NBR-based) with a hardness of approx. 80 Shore A, which has been tried and proven in pneumatics for many years. this compound offers excellent running properties, especially in the semi-frictional area. for high and/or low temperature applications special compounds are available.

the stated operation conditions represent general indications. it is recommended not to use all maximum values simultaneously. surface speed limits apply only to the presence of adequate lubrication film.

¹ attention: not suitable for mineral oils!

surface quality

surface roughness	Rtmax (µm)	Ra (µm)
running surface	≤ 2.5	0.05-0.60
bottom of groove	≤ 6.3	≤ 1.6
side of groove	≤ 15	≤ 4.0

tolerance recommendation

seal housing tolerances	
Ød	e9
ØD	H9

fitting & installation

the profile S01-SC lip seals can be easily snapped into the groove. to avoid damaging the seal lips during installation, sharp edges should be removed from around the installation groove. the groove dimensions determine the size of the dynamic lip. it is therefore essential to ensure that the groove is accurately machined. it is important to maintain a full lubrication film on the rod when running under non-lubricated conditions. lubrication should take place during assembly. when using the profile S01-SC lip seal under non-lubricated conditions, care should be taken to ensure that the lubrication film is not destroyed by the wiper. for this case we recommend our wiper profile A01-SB, specially designed for pneumatics.

**note:**

for nominal diameters $\varnothing \leq 25$ mm an open housing is recommended, according to the cross-section of the seals and the position of the groove (stuffing box installation).

seal & housing recommendations

please note that we are able to produce those profiles to your specific need or any non standard housing. for detail measurements, please see seal-mart catalog...

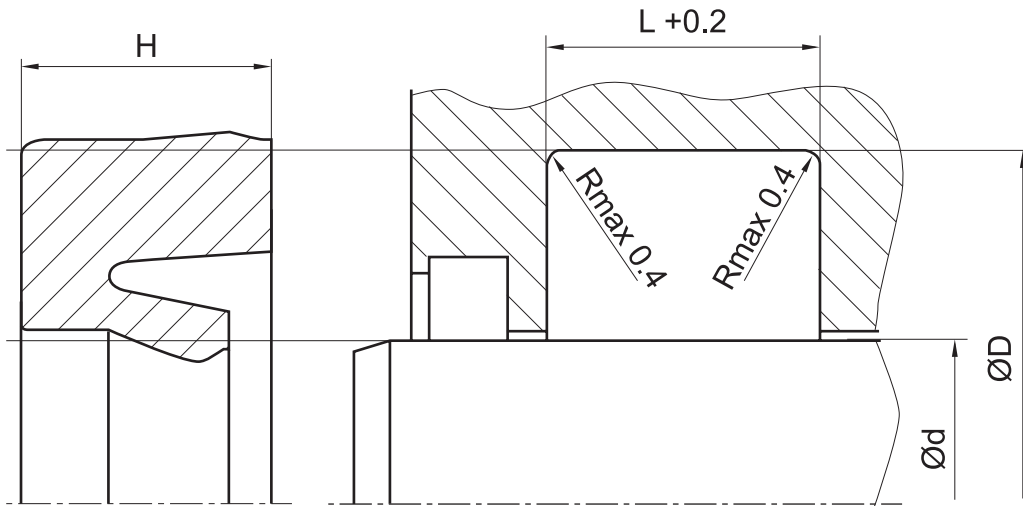

don't hesitate to contact our technical department for further information or for special requirements (temperature, speed etc.), so that suitable materials and/or designs can be recommended.